

WORKERS SAFETY AROUND THE BELT CONVEYOR
The Customer is obliged to provide the necessary safety equipment as mentioned in the European law 72, also of the year 2008 to avoiding the direct contact of the workers of the working parts during the working. It will be necessary to clear the zone of risk, with suitable the working areas, to prevent a permanent blocking or to covering the moving parts. It's suggested to study a safety risk plan that cover, and also a safety work way for the daily work and operations.
The workers must be instructed of the right way for the maintenance operations like the LOCKOUT-TAGOUT of the conveyor.
All other external people must stay away from the conveyor.
Read the use and maintenance manual carefully before use.

PERIMETRIC CATWALK SUPPORT:
The structure/profile to support the intermediate catwalk of the side walls and at the two end walls has to be erected to the Customer's accordance to the local rules and regulations and have to be calculated based on the below loads.
Live load = 225kg/sqm
Dead load = 35kg/sqm
The intermediate catwalk must be bolted to the equipment at one side (close equipment side), and it must be free standing (not fixed/bolted) on the side walls and at the two end walls.

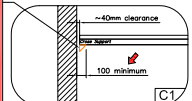

Aviary System Laying Stocking Density Calculation:
Chamber Width= 11,0m
Chamber Length= 110,00m
System Layout= 1 Row of "Volo Rocca" x 35 Sections (2,9m each section)
"Volo Rocca" usable area per meters 7,38m²
Usable area length: 35 sections x 2,9m = 101,5m
m² of usable area on the "Volo Rocca": 7,38m² x 101,5m = 749,07m²
m² of usable area on the Floor: 11,0m x 101,5m = 1116,5m²
Total m² usable area: 749,07m² + 1116,5m² = 1865,57m²
Guaranteed capacity from the total usable area (Floor+ "Volo Rocca"): 1865,57m² x 9birds/m² = 16,790 birds
Guaranteed capacity from the floor usable area: 1116,5m² x 15birds/m² = 16,747 birds
Guaranteed capacity from the Nests Area: 3nests x 0,5m nests width x 101,5m=152,3m² x 120birds/m²= 18,270 birds
Guaranteed capacity from the Feed Trough: 8troughs x 24ides x 10150cm = 162400cm / 10cm trough/birds= 16,240 birds
SYSTEM CAPACITY LIMIT: 16,240 birds

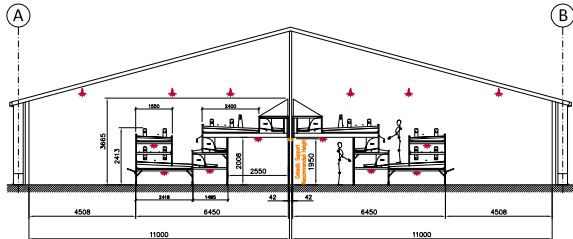

CONFIDENTIAL

THIS IS ONLY A PRELIMINARY DRAWING AND NOT THE FINAL ONE, SO IT COULD BE SUBJECT TO FURTHER UPDATING AND MODIFICATION

Drawing not to scale
Where not expressly dimensioned the represented sizes are only indicative and not binding

Any details in the present design may appear as in contrast or in contradiction with other information and / or measurements in the same, do not allow any people operating in the installation of the equipment, to undertake arbitrary and operative choices in order to solve any eventual problem, without having previously consulted with VALLI S.r.l. staff.

Concrete works and steel/wood constructions, which are not supplied by VALLI, are drawn only as demonstrative purpose and so they must be designed by the Customer's designer engineer.

VALLI VALLI S.r.l. via Selva 14, 47122 FORLÌ - ITALY Ph. +39 0543 979311 info@valli-italy.com - www.valli-italy.com		United Kingdom		Production Sheet: 0000
Customer Model: VOLLO ROCCA		Ref. Customer: -		Offer: -
Total Capacity: 16,000 each chamber		Designer: Marco Bigoni		DRG.: CF2836
Feeding System: Flat Chain		Scale: 1:100		
Egg Collector: Onside Director System		Ref. Org: -		

This drawing is property of VALLI S.r.l. therefore it must not be copied, reproduced, given to third parties or used for different purposes than the ones it was created for. The author reserves all rights. VALLI S.r.l. is the sole and exclusive owner of this drawing and all protect its rights in accordance with the laws.